



NC STATE

THINK AND DO
THE EXTRAORDINARY

Administrative Leadership Meeting

Randy Woodson
Chancellor

Tuesday, July 10, 2018

Upcoming ALMs

September 18, 2018

Employee Engagement

Titmus

November 20, 2018

Strategic Plan Report Card

Titmus



Continued Positive Trajectory for Student Success

- Largest incoming freshman class in history
- Transfer student pipeline
- Increasing graduation rates

Think and Do the Extraordinary Campaign Momentum Strong

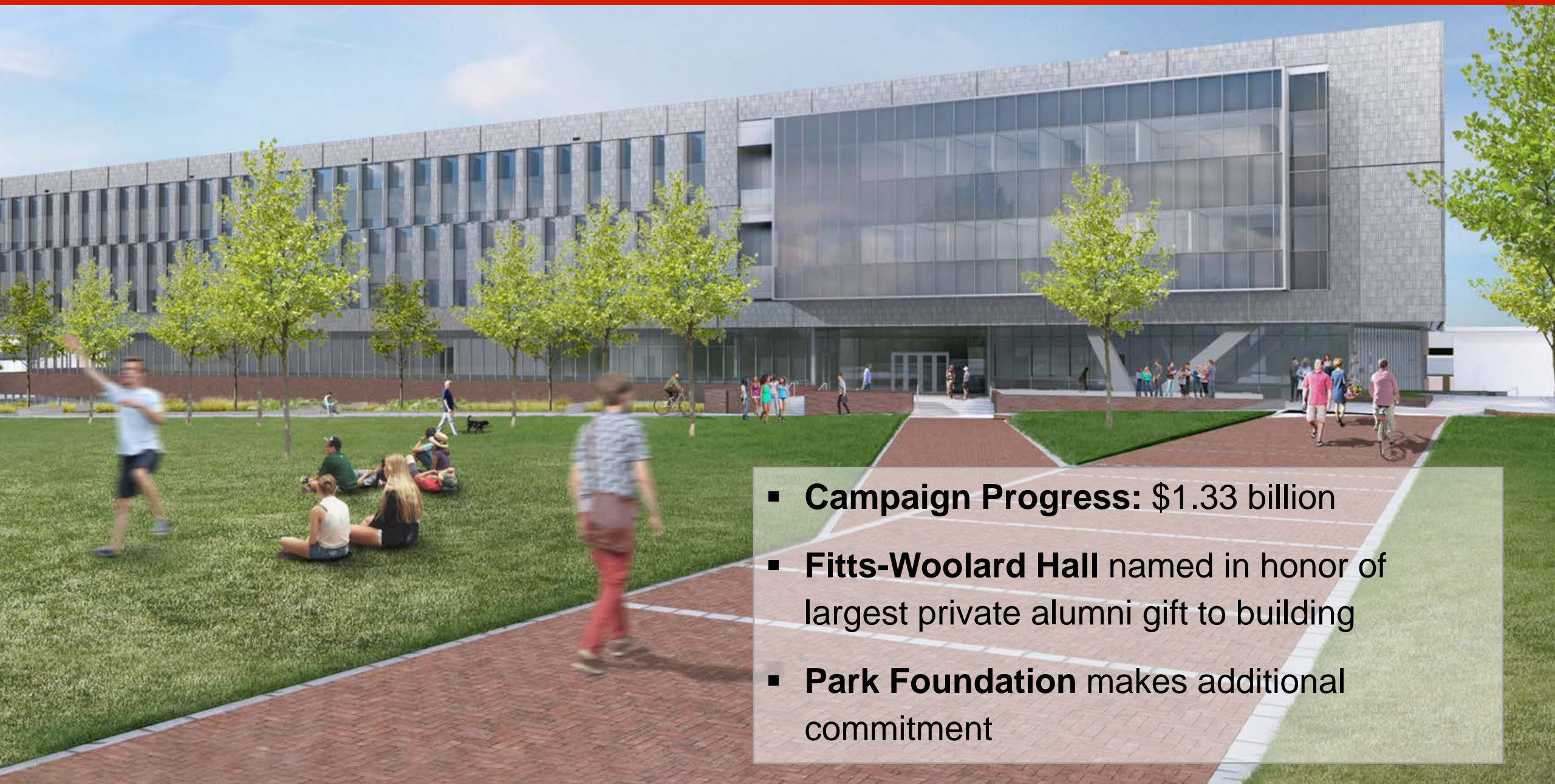

- **Campaign Progress:** \$1.33 billion
- **Fitts-Woolard Hall** named in honor of largest private alumni gift to building
- **Park Foundation** makes additional commitment

Questions?



UNDERSTANDING OUR RANKINGS

Administrative Leadership Meeting • July 10, 2018

Warwick Arden, Executive Vice Chancellor and Provost



Importance of Rankings

Shapes
perceptions of
NC State for

- Prospective and current students
- Prospective and current faculty and staff
- Other institutions and prospective partners
- Funding agencies (including other countries)
- Public at large

Can be a tool for measuring strategic success

Limitations of Rankings

Multiple rankings, with different audiences, methodologies and results

Not all universities participate

No agreement in Higher Ed about what to measure and how to rank institutions

Lag current data by a year or two

Types of Indicators

Student
Selectivity

Instructional
Impact

Institutional
Resources

Reputational

Student
Success

Faculty
Productivity:
Research \$

Faculty
Productivity:
Bibliometric

Faculty
Productivity:
Awards

Data Sources

{ Common
Data Set }

{ National
Academies }

{ Council for Aid
to Education }

{ NACUBO }

{ Award-granting
organizations }

{ Clarivate
Analytics }

{ Reputation
surveys }

{ Scopus abstract
and citation
database }

{ National Science
Foundation }

{ Web of
Science }

{ Information
provided by
universities }

{ IPEDS }

NC State and Peers – Fall 2016

Institution	Land Grant	Medical School	Vet School	Total Students	% UG Students	Student/Faculty Ratio
Colorado State University	X		X	33,058	78%	18/1
Georgia Institute of Technology				26,839	58%	20/1
Iowa State University	X		X	36,350	84%	19/1
Michigan State University	X	X	X	50,344	78%	17/1
NC State University	X		X	33,755	71%	13/1
Ohio State University	X	X	X	59,482	77%	19/1
Penn State University-Main Campus	X	X		47,789	87%	16/1
Purdue University-Main Campus	X		X	40,451	74%	12/1
Rutgers University	X			50,146	72%	13/1
Texas A & M University	X	X	X	65,302	78%	21/1
University of Arizona	X	X		43,625	78%	22/1
University of California-Davis	X	X	X	36,441	81%	20/1
University of Florida	X	X	X	52,367	66%	20/1
University of Illinois-Urbana/Champaign	X		X	46,951	72%	20/1
University of Maryland-College Park	X			39,083	73%	17/1
University of Wisconsin-Madison	X	X	X	43,336	73%	18/1
Virginia Polytechnic Institute	X		X	33,170	78%	14/1

Data from 2016-17 Common Data Set

DOMESTIC RANKINGS

Comparison of Domestic Rankings



PURPOSE:

To help prospective undergraduate students find the right college

To help prospective graduate students find programs

To improve the performance of American research universities

Primary source of information on R&D expenditures at U.S. universities

DOMINANT INDICATORS:

- Reputation
- Student Success

- Reputation

- Faculty Productivity (Research Expenditures and Awards)

- Faculty Productivity (Research Expenditures)

U.S. News and World Report: Undergraduate Rankings

colleges.usnews.rankingsandreviews.com/best-colleges

- **Purpose:** To help prospective students and their families find the right college
- **Population (National Universities):** Universities that offer a full ranges of undergraduate majors, plus master's and doctoral programs, and emphasize faculty research; 230 individually-ranked schools
- **Frequency:** Annual
 - 2018 edition released September 2017



U.S. News: Undergraduate Rankings
NC State Overall Rank
2011 to 2018 Editions

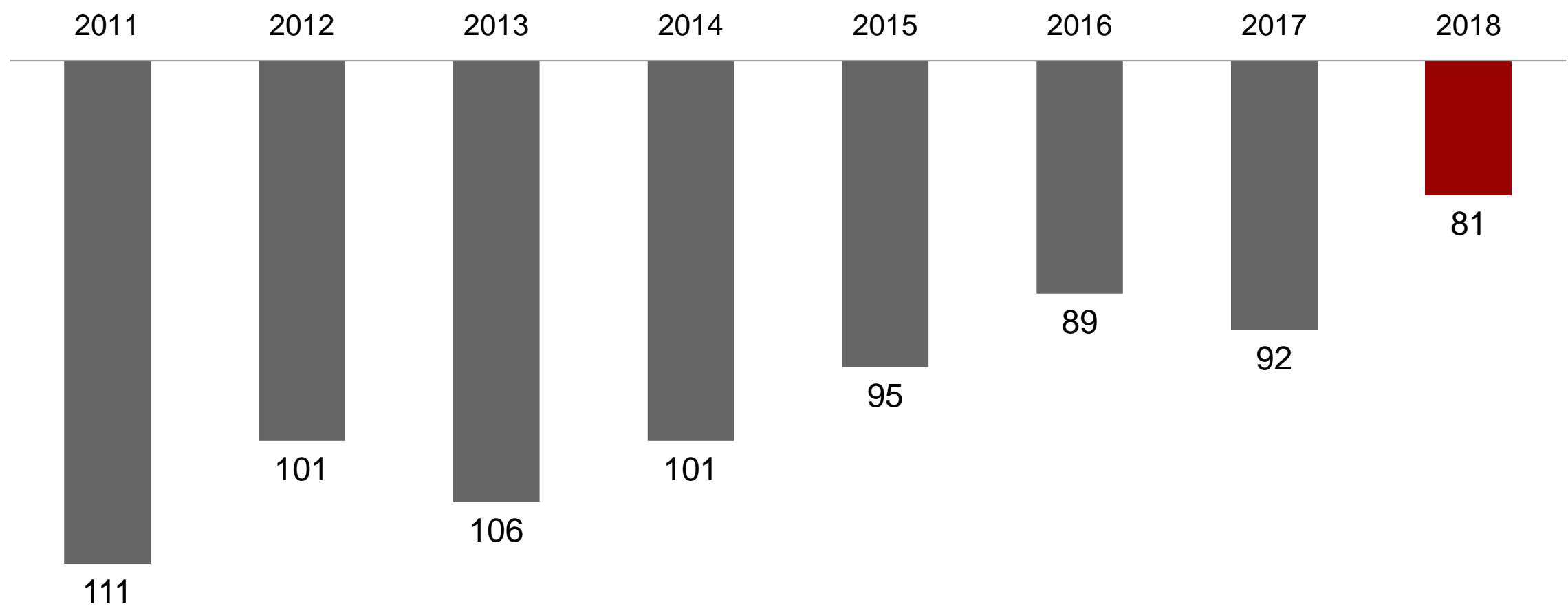

U.S. News and World Report: Undergraduate Rankings

2018 Edition Methodology

Category	% of rank	2018 Ranking Metric	Subfactor Weight	Overall Weight
Undergraduate Academic Reputation	22.5%	Peer assessment (ave spring 2016 and 2017 surveys)	66.7%	15%
		High school counselor rating score (ave. spring 2015, 2016, 2017 surveys)	33.3%	7.5%
Graduation & Retention	22.5%	Freshman retention (ave. 2012-15 cohorts)	20%	4.5%
		6 Year graduation rate (ave. 2007-10 cohorts)	80%	18%
Graduation Rate Performance	7.5%	6 Year graduation rate (2010 cohort)	100%	7.5%
		Predicted 6 year graduation rate		
Faculty Resources	20%	Class size index (fall 2016)	40%	8%
		Student/faculty ratio (fall 2016)	5%	1%
		% Full time faculty (2016-17 academic year)	5%	1%
		Faculty compensation (ave. 2015-16 and 2016-17 academic years)	35%	7%
		% Full time faculty with terminal degree (2016-17 academic year)	15%	3%
Student Selectivity	12.5%	Ave. Math SAT, Ave. Verbal SAT, Composite ACT (fall 2016 cohort)	65%	8.125%
		% Entering freshmen in top 10% of HS class (fall 2016 cohort)	25%	3.125%
		Acceptance rate (fall 2016 admission)	10%	1.25%
Financial Resources	10%	Educational expenditures per student (ave. FY 2015 and FY 2016)	100%	10%
Alumni Giving	5%	Alumni giving rate (ave. 2014-15 and 2015-16 academic years)	100%	5%

U.S. News: Undergraduate Rankings
NC State - Category Ranks
2016 to 2018 Editions

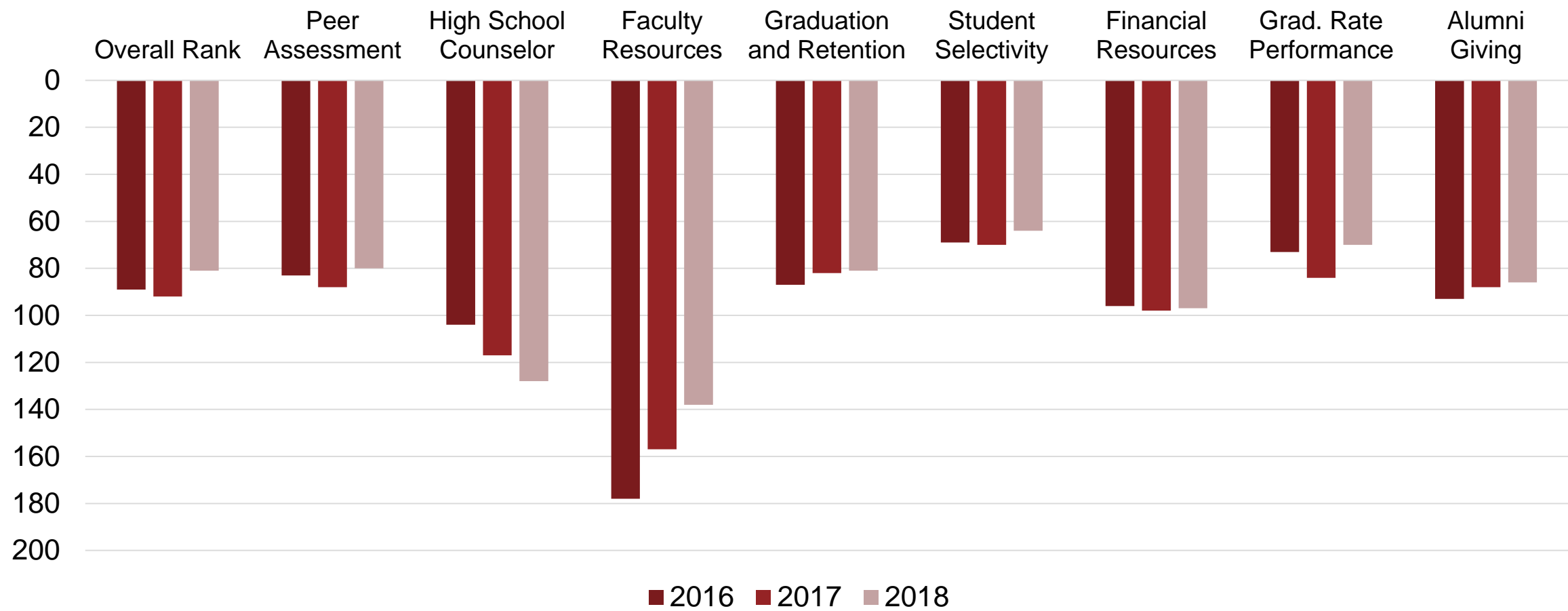

U.S. News: Undergraduate Rankings
2018 Edition - Category Ranks

NC State vs. 16 Peers (average)
(Column widths represent category weight)

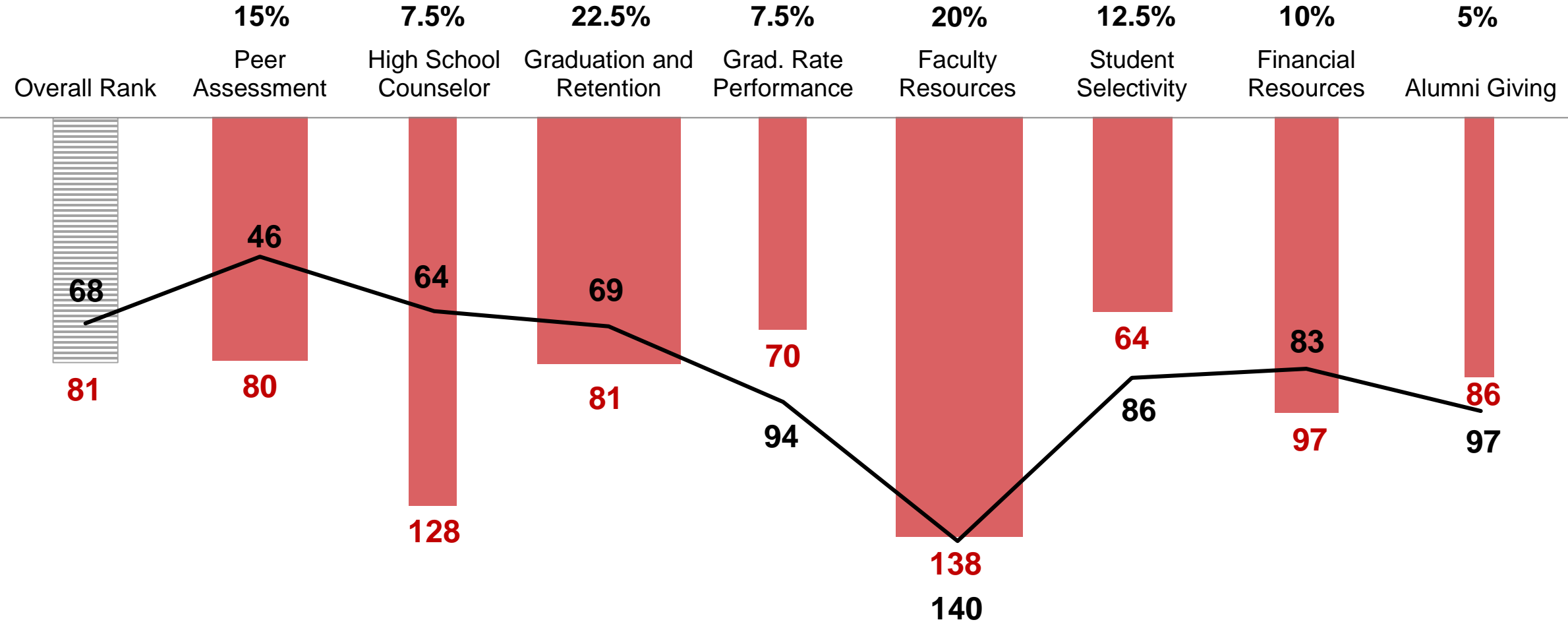

U.S. News: Undergraduate Rankings
Faculty Resources - NC State

% of Rank	Subfactor Weight	Overall Weight	Metric		2016	2017	2018
					Rank: 178	Rank: 157	Rank: 138
					Score	Score	Score
20%	40%	8%	% Classes with < 20 students	Class Size Indicator Rank used in 2017+	28.3%	227	194
			% Classes with ≥ 50 students		16.8%		
	5%	1%	Student/faculty ratio		16/1	14/1	13/1
	5%	1%	% Full time faculty		93.9%	95.1%	94.8%
	35%	7%	Faculty compensation (x 1,000)		\$118.00	\$127.57	\$132.61
	15%	3%	Faculty with terminal degree		90.7%	92.4%	91.9%

U.S. News: Undergraduate Rankings – 2018 Edition: Faculty Resources

		Weight of Metric
Rank	Tie	School
30	*	University of North Carolina-Chapel Hill
34	*	Georgia Institute of Technology
42	*	University of Florida
46	*	University of Wisconsin-Madison
46	*	University of California-Davis
52	*	University of Illinois at Urbana-Champaign
52	*	Pennsylvania State University
54	*	Ohio State University
56	*	Purdue University
61	*	University of Maryland-College Park
69	*	Texas A & M University
69	*	Virginia Polytechnic and State University
69	*	Rutgers University-New Brunswick
81	*	Michigan State University
81	*	North Carolina State University
115	*	Iowa State University
124	*	Colorado State University
124	*	University of Arizona

	8%	1%	1%	7%	3%
Faculty resources rank	Class Size Indicator Rank	Student/ faculty ratio	% Full Time Faculty	Faculty Compensation Rank	Faculty with Terminal Degree
94	186	13/1	92%	52	86%
178	271	20/1	97%	35	81%
89	157	20/1	93%	65	89%
106	263	20/1	89%	27	92%
124	208	18/1	94%	87	91%
83	220	20/1	100%	35	94%
166	271	16/1	96%	35	81%
166	274	19/1	88%	81	98%
74	220	12/1	95%	57	98%
128	176	17/1	88%	119	91%
106	233	13/1	73%	62	99%
184	294	21/1	92%	28	89%
166	278	14/1	96%	65	90%
210	280	17/1	95%	94	90%
138	194	13/1	95%	126	92%
194	281	19/1	94%	77	93%
145	194	22/1	94%	94	89%
128	239	18/1	99%	103	100%

Note: Shading indicates values that are below NC State's for a given metric

U.S. News: Undergraduate Rankings

Specialized Lists – 2016 v. 2018



Best Value Colleges

- 2016: 50
- 2018: 46



Best Colleges for Veterans

- 2016: 72
- 2018: 44



Best Business Programs

- 2016: 93
- 2018: 91



Best Engineering Programs

- 2016: 31
- 2018: 34

U.S. News and World Report: Graduate Edition

grad-schools.usnews.rankingsandreviews.com/best-graduate-schools

- **Purpose:** To help prospective graduate students find programs
- **Population:** Varies by program/discipline
- **Frequency:** Annual (in most disciplines)
 - 2019 edition released March 2018

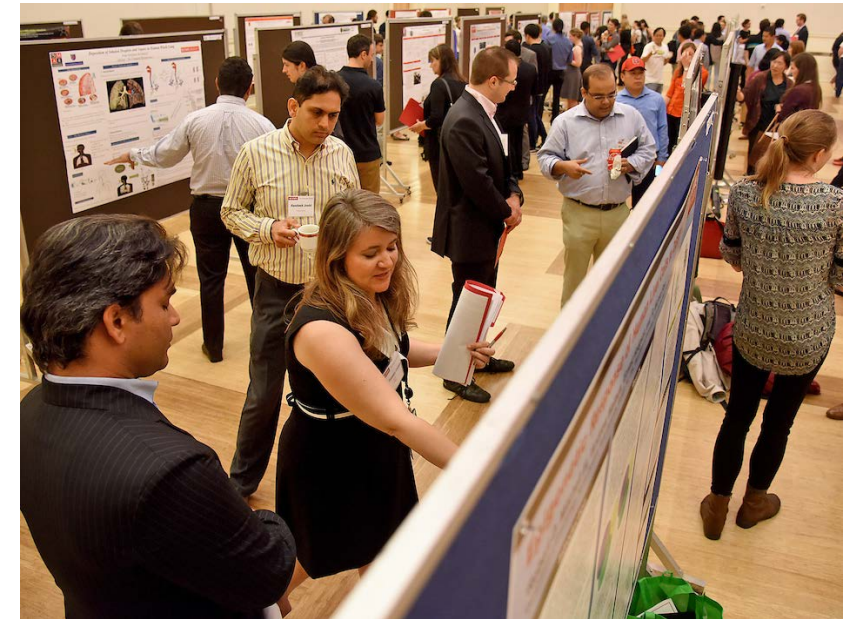

U.S. News: Graduate Edition

NC State – Public Affairs, Science, Social Sciences and Humanities, Education, Business and Health

2017 Edition vs. **2019 Edition**

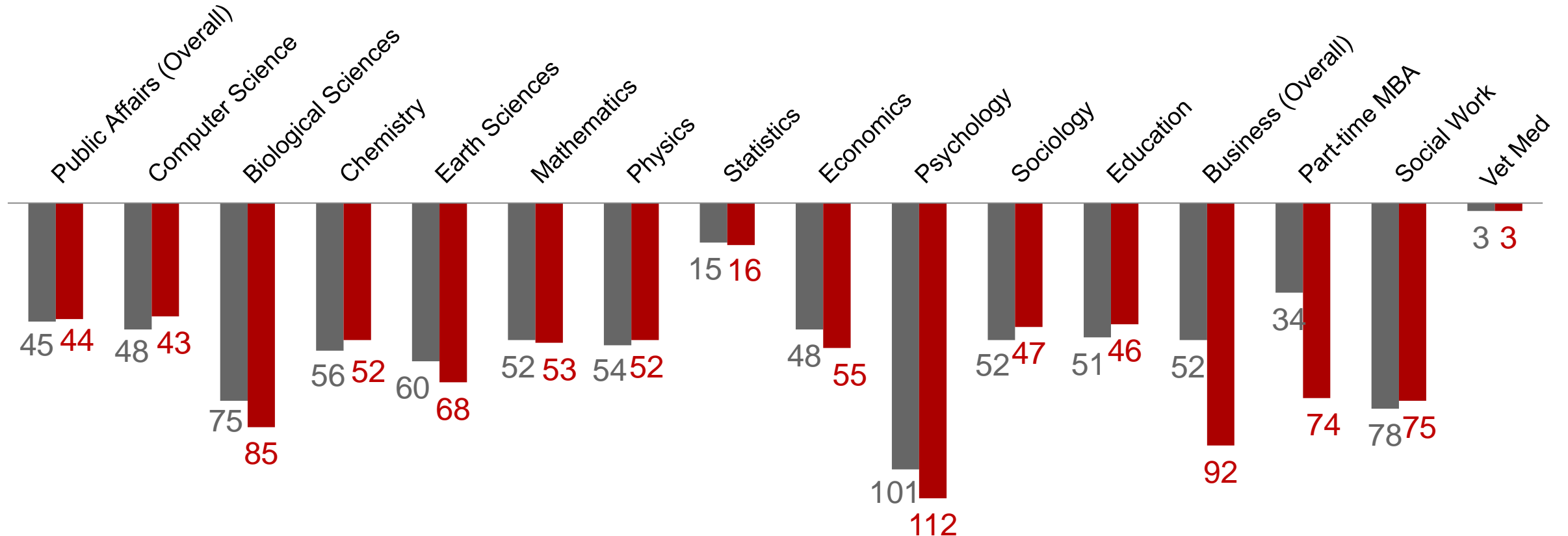

U.S. News: Graduate Edition
NC State - Engineering
2017 Edition vs. 2019 Edition

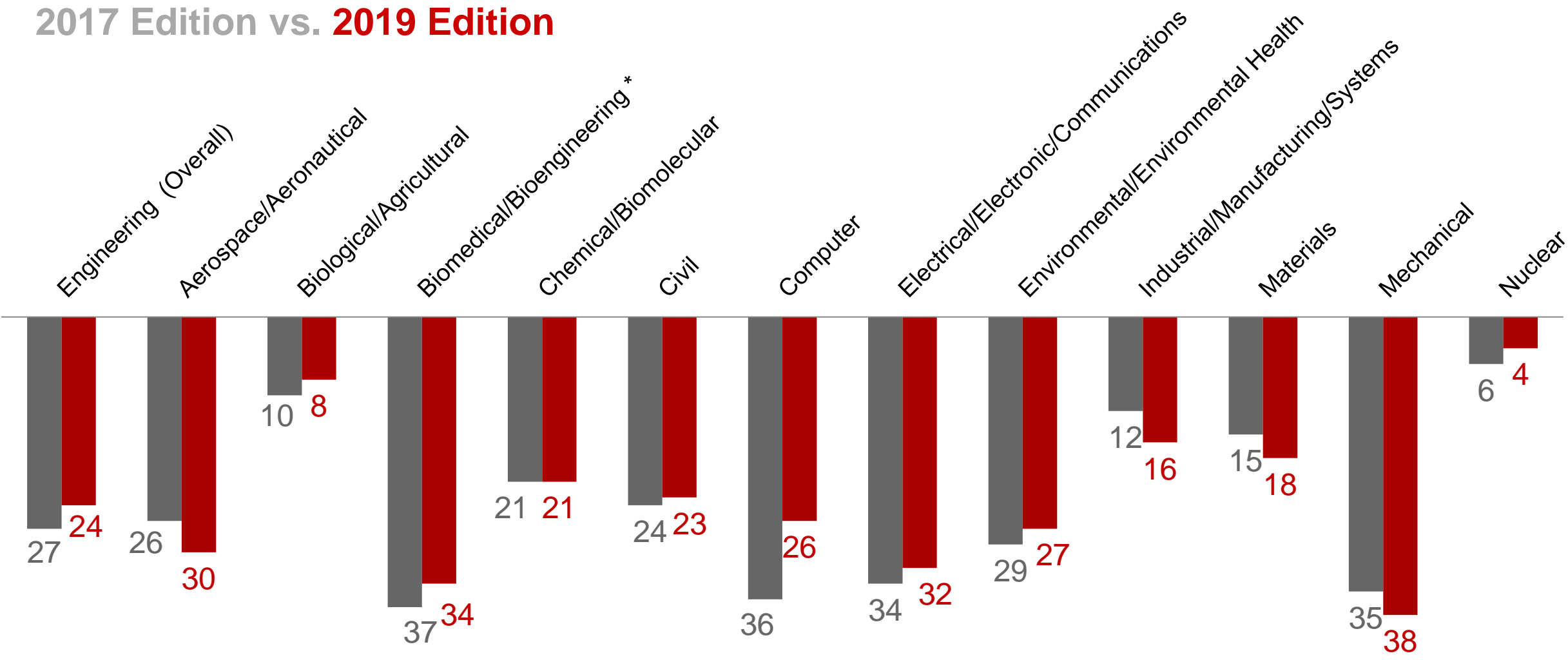

* Joint department with UNC-CH

Center For Measuring University Performance

mup.asu.edu/Top-Universities

- **Purpose:** To improve the performance of American research universities
- **Population:** Institutions with \$40+ million in annual federal research expenditures; 160 institutions met the criteria
- **Frequency:** Annual report on *The Top American Research Universities*
 - 2016 edition released Fall 2017



Center For Measuring University Performance

2016 Report

Category*	Data Source
Total research expenditures	NSF Higher Education Research and Development (HERD) Survey, FY 2014
Federal research expenditures	NSF Higher Education Research and Development (HERD) Survey, FY 2014
Endowment assets	NACUBO-Commonfund Study of Endowment, endowment market value as of June 30, 2015
Annual giving	Council for Aid to Education's Voluntary Support of Education (VSE) Survey, FY 2015
National Academy members	National Academies of Sciences, Engineering and Medicine membership directories for 2015
Faculty awards	Directories or web-based listings for multiple agencies or organizations. Years vary (2014-15 to 2015-16).
Doctorates awarded	NCES IPEDS Completions Survey, doctoral degrees awarded between July 1, 2014 and June 30, 2015.
Postdoctoral appointees	NSF/Division of Science Resource Statistics (SRS) Survey of Graduate Students and Postdoctorates in Science and Engineering, Fall 2014
SAT Scores	NCES IPEDS Survey, SAT scores for Fall 2014.

*All categories have equal weight.

Center For Measuring University Performance



2016 Report: NC State

Category	Top American Research Universities 2016 Edition		
	Year's Value	Rank Among Publics	Rank Among All
Rank		27	53*
Total research expenditures x \$1000 (FY 2014)	\$440,392	27	44
Federal research expenditures x \$1000 (FY 2014)	\$177,722	44	70
Endowment assets x \$1000 (FY 2015)	\$983,979	32	89
Annual giving x \$1000 (FY 2015)	\$119,150	41	72
National academy members (2015)	20	31	58
Faculty awards (2014-15 to 2015-16)	11	33	58
Doctorates granted (FY 2015)	512	23	31
Postdoctoral appointees (Fall 2014)	473	18	38
Median SAT (Fall 2014)	1245	27	114

Notes

*6 institutions share 53rd on the overall list with NC State University

Source: <http://mup.asu.edu/>

 Top 25
 Top 26-50

Center For Measuring University Performance

NC State: 2013-2016 Reports

Category	Top American Research Universities Edition											
	2013			2014			2015			2016		
Overall rank among all institutions	60			52			51			53		
Number of measures in top 25 among all	0			0			0			0		
Number of measures in top 26-50 among all	2			4			4			3		
Overall rank among public institutions	43			25			27			27		
Number of measures in top 25 among public	0			3			2			2		
Number of measures in top 26-50 among public	8			5			7			7		
	Value	Public Rank	National Rank	Value	Public Rank	National Rank	Value	Public Rank	National Rank	Value	Public Rank	National Rank
Total research expenditures x \$1000	\$374,446	33	54	\$400,046	33	52	\$413,524	31	49	\$440,392	27	44
Federal research expenditures x \$1000	\$152,790	48	78	\$171,464	44	72	\$174,440	44	70	\$177,722	44	70
Endowment assets x \$1000	\$635,326	40	108	\$769,404	37	97	\$885,055	34	93	\$983,979	32	89
Annual giving x \$1000	\$100,324	40	64	\$131,378	24	46	\$117,535	35	66	\$119,150	41	72
National Academy members	19	30	56	18	30	58	20	30	57	20	31	58
Faculty awards	12	30	50	14	24	44	12	27	48	11	33	58
Doctorates granted	446	26	37	488	21	31	494	21	31	512	23	31
Postdoctoral appointees	318	29	54	371	26	48	490	18	36	473	18	38
Median SAT	1185	57	220	1185	57	216	1225	36	151	1245	27	114

Center for Measuring University Performance
2016 Report – Ranks among Public Institutions

NC State vs. 16 Peers (average)
(all categories have equal weight)

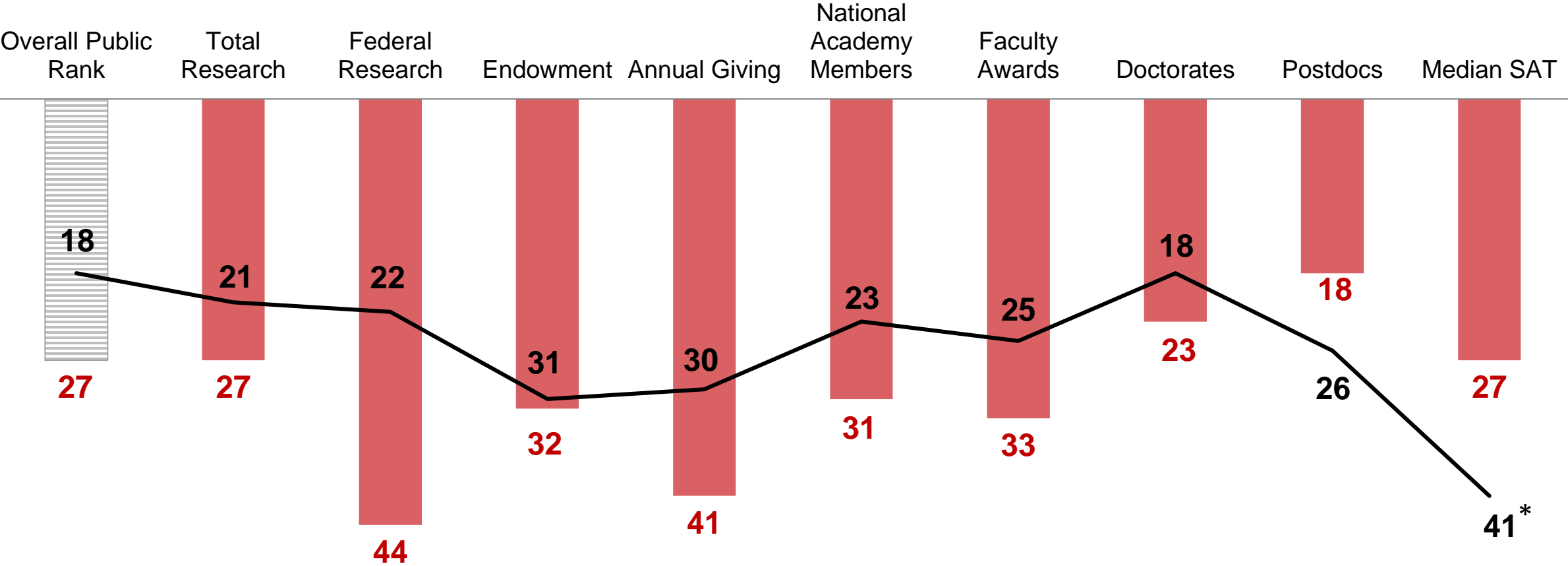

*Average among 15 peers. No median SAT listed for University of Arizona.

NSF Higher Education Research and Development (HERD) Survey

ncesdata.nsf.gov/herd/2016/

- **Purpose:** Primary source of information on R&D expenditures at U.S. colleges and universities
- **Population:** Institutions that expended at least \$150,000 in separately accounted for R&D in the fiscal year.
- **Frequency:** Annual
 - FY 2016 edition released November 2017



NC State FY 2011-16 NSF Higher Education
R&D Expenditures By Source of Funds
Rank listed is among Public Institutions

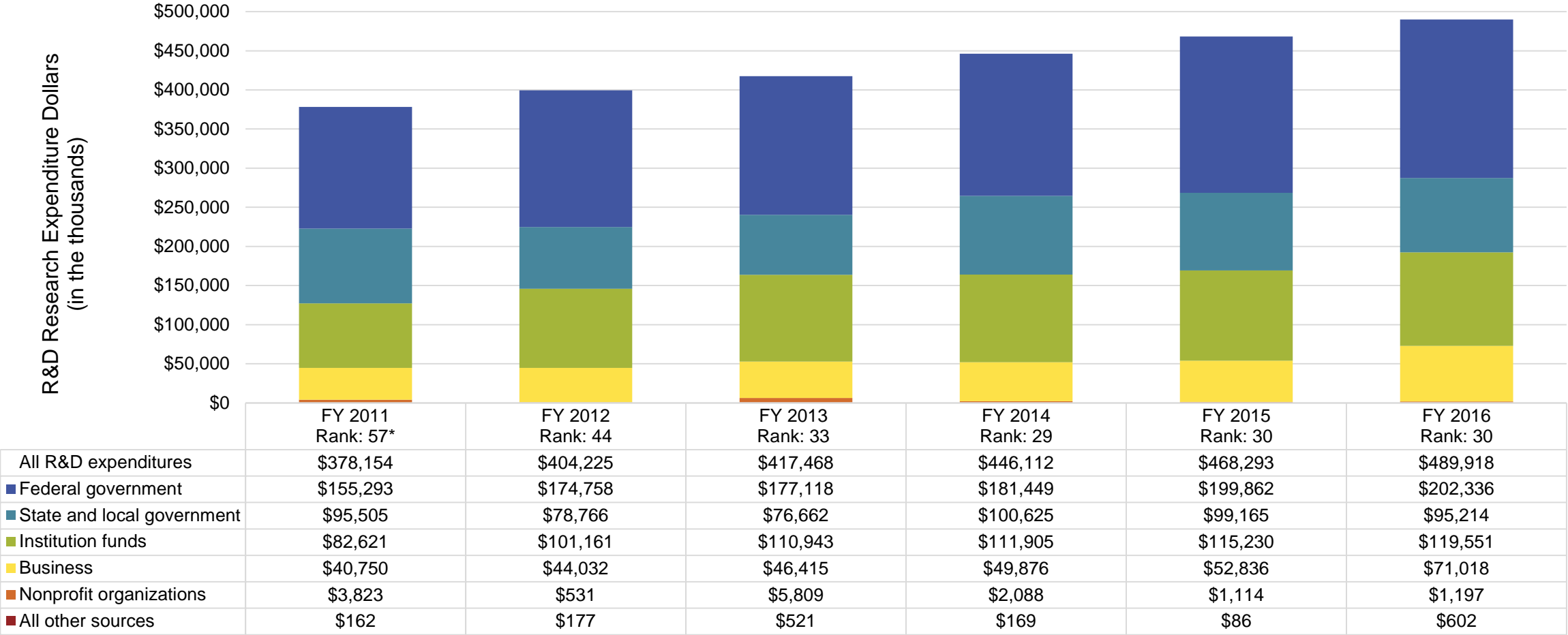

* FY 2011 rankings included all national institutions, all others include public institutions only

NSF Higher Education R&D Expenditures at NC State & Peer Institutions
without Medical Schools By Source of Funds: FY 2016
Rank listed is among Public Institutions

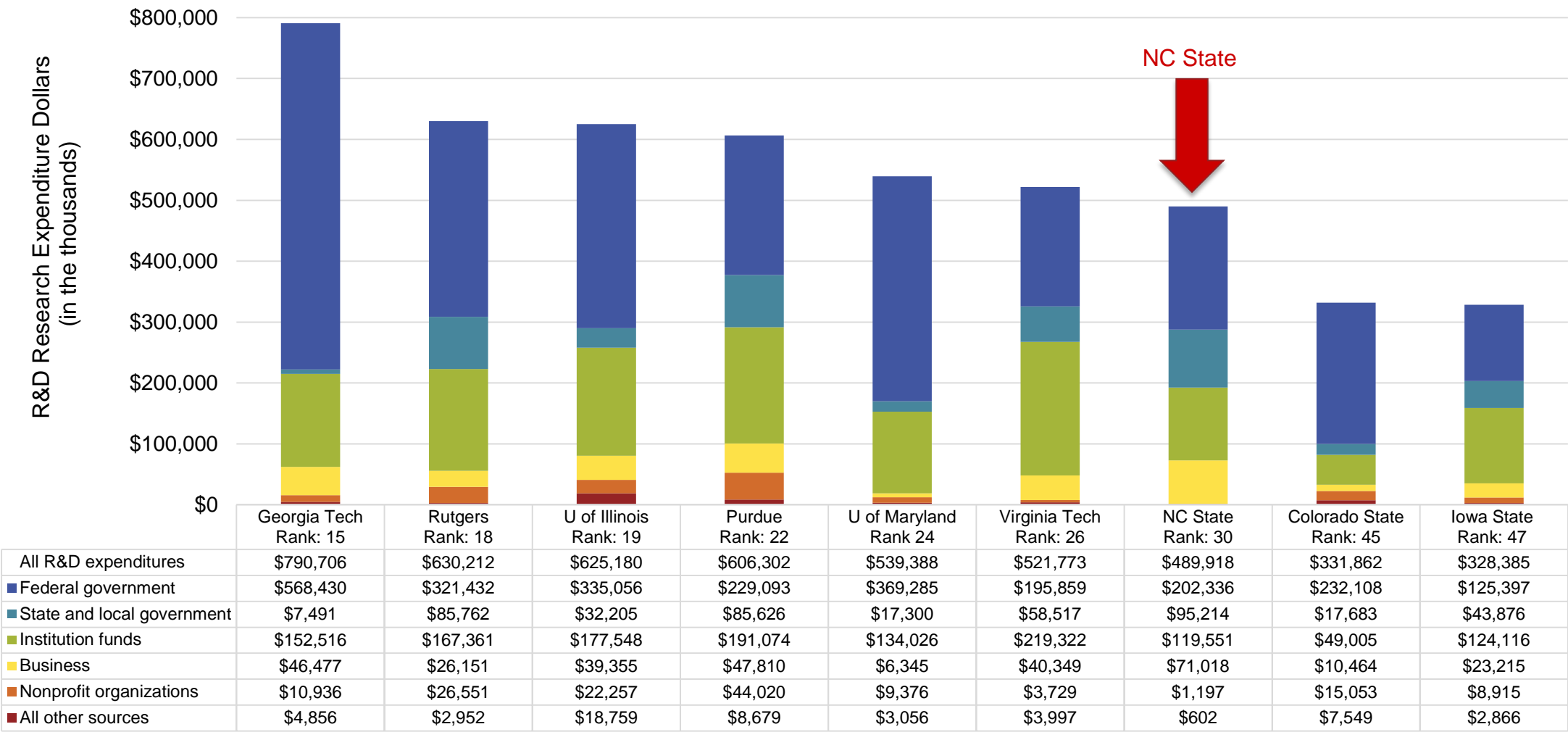

GLOBAL RANKINGS

Comparison of Global Rankings



PURPOSE:

To help students make informed comparisons of leading universities around the world

Judge world class universities across all of their core missions – teaching, research, knowledge transfer and international outlook

The initial purpose of ARWU was to find the global standing of top Chinese universities; now recognized for its scientifically sound, stable and transparent methodology

To allow students to compare universities around the world based on academic research and reputation

DOMINANT INDICATORS:

- Reputation
- Faculty Productivity (Bibliometrics)

- Reputation
- Faculty Productivity (Bibliometrics)

- Faculty Productivity (Bibliometrics and Awards)

- Faculty Productivity (Bibliometrics)
- Reputation

QS (Quacquarelli Symonds) World University Rankings

www.topuniversities.com/qs-world-university-rankings

- **Purpose:** To allow students to compare universities around the world based on academic research and reputation
- **Population:** Considers over 1,000 universities based on six performance indicators
- **Frequency:** Annual
 - 2019 edition released June 2018

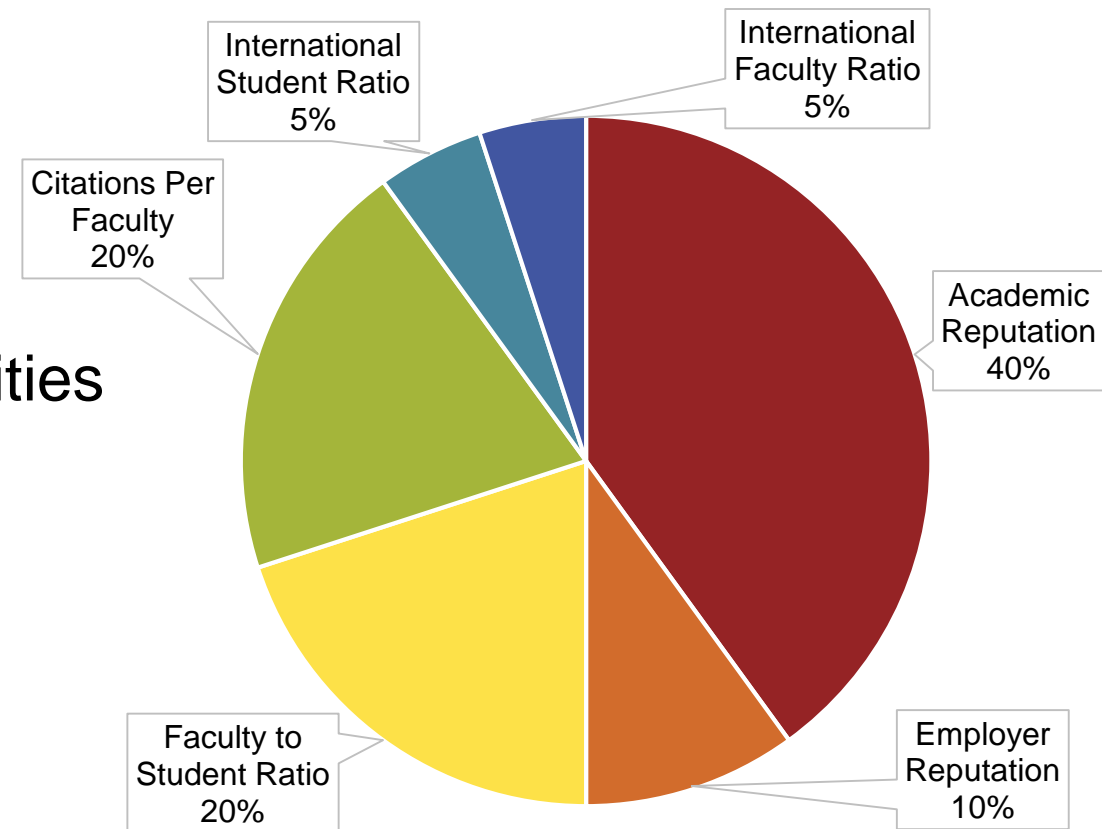

QS World University Rankings
NC State - Category Scores
2017 to 2019 Editions

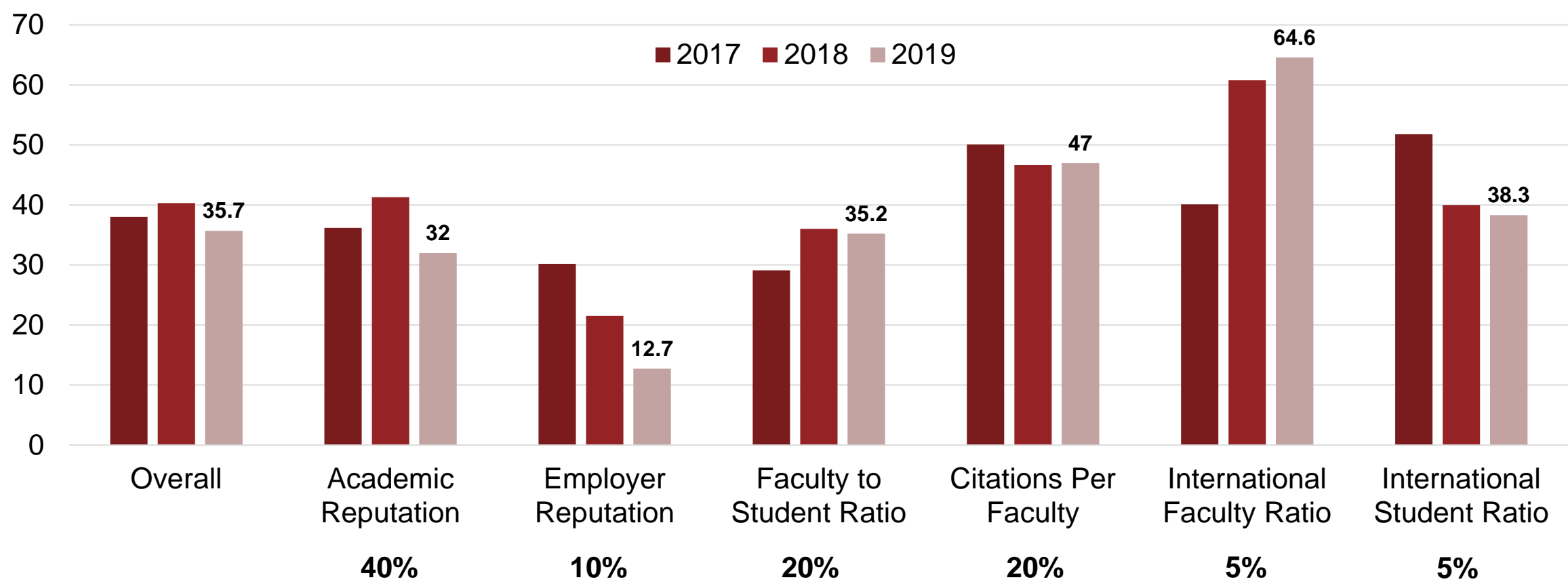

QS World University Rankings
2019 Edition - Category Scores

NC State vs. 16 Peers (average)
(Column widths represent category weight)

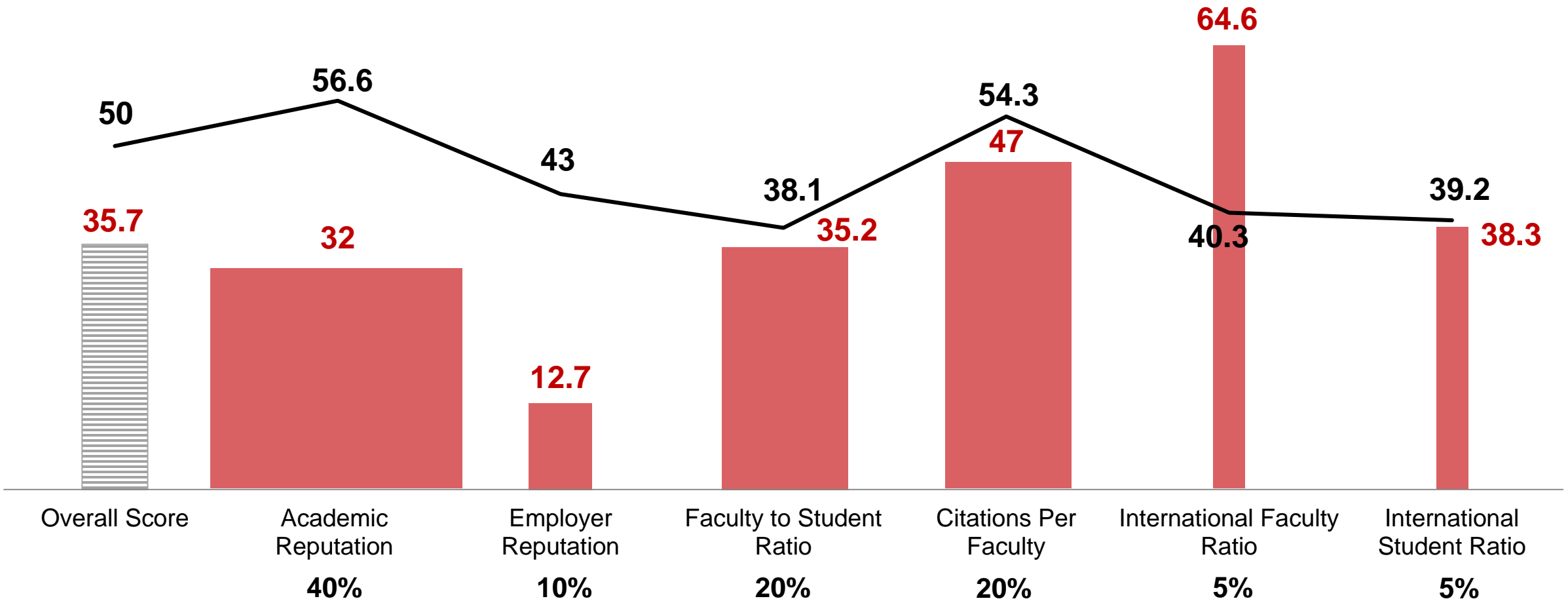

QS World University Rankings
2019 Edition - Overall Rank

NC State, 16 Peers and UNC-CH

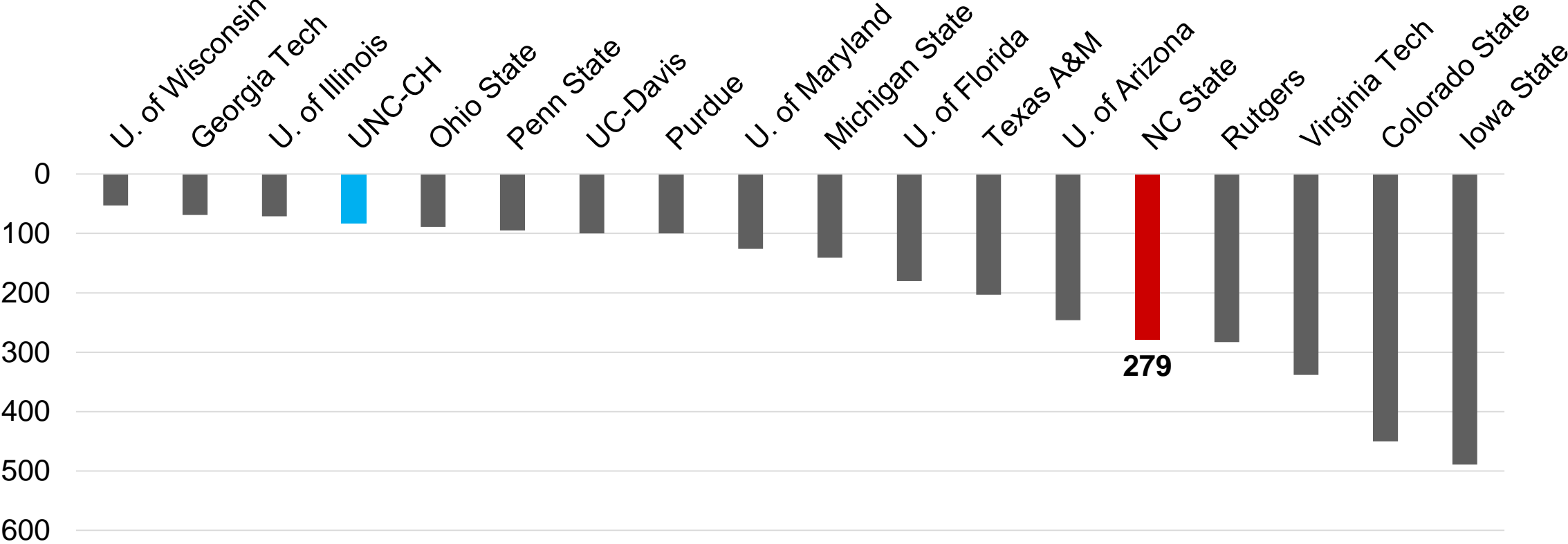

Times Higher Education (2018 Edition)
ARWU (2017 Edition)
Overall Ranks

NC State, 16 Peers and UNC-CH

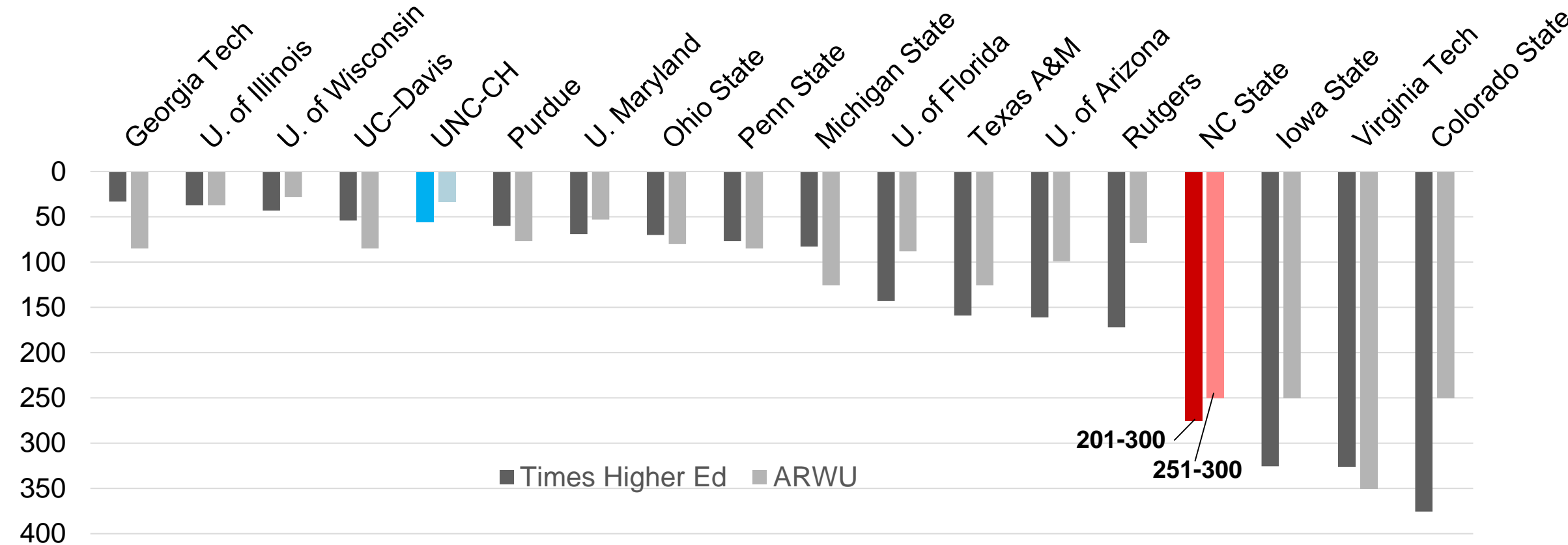

Note: Plotted mid-points if rank range was listed for an institution.

U.S. News and World Report: Best Global University

www.usnews.com/education/best-global-universities

- **Purpose:** To allow students to compare universities around the world based on academic research and reputation
- **Population:** Top 250 universities in Clarivate Analytics' global reputation survey and institutions that published the highest number of articles over 5 years; 1,250 institutions
- **Frequency:** Annual
 - 2018 edition released October 2017

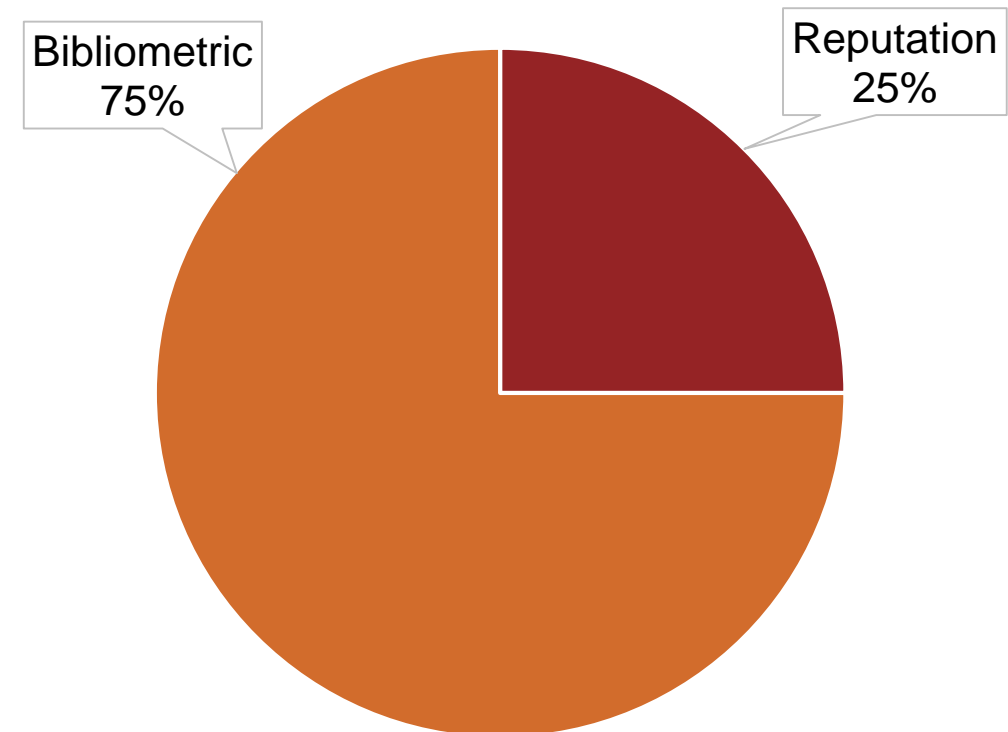

U.S. News: Best Global University

NC State – 2016 v. 2018 Editions

Category	Indicator	Weight (2018)	Source	2016	2018
	Global Rank			212	222
	Global Score			57.4	56.9
Reputation	Global research reputation rank	12.5%	Thomson Reuters'/ Clarivate Analytics' Academic Reputation Survey	188	146
	Regional research reputation rank	12.5%		57	54
Bibliometric	Publications rank	10%	From Web of Science for the five-year period 2018: from 2011 to 2015 2016: from 2009 to 2013	162	170
	Books rank	2.5%		175	168
	Conferences rank	2.5%		146	140
	Normalized citation impact rank	10%		429	505
	Total citations rank	7.5%		183	191
	Number of publications that are among the 10 percent most cited rank	12.5%		190	177
	% of total publications that are among the 10 percent most cited rank	10%		427	419
	International collaboration rank	5% - 2016 10% - 2018		571	571
	% of total publications with international collaboration rank	5%			782
	Number of highly cited papers among top 1% most cited in respective field rank	5%			219
	% of total publications that are among the top 1% of most highly cited papers rank	5%			496
School-Level	Number of Ph.D.s awarded rank (2016: 5% of total; 2018: N/A)		Publically available data sources	184	
	Number of Ph.D.s awarded per academic staff member rank (2016: 5% of total; 2018: N/A)			182	

U.S. News: Best Global University

NC State – 2016 v. 2018 Editions

Subject Rankings

Subject	2016 Global Rank	2018 Global Rank
Agricultural Sciences	38	46
Biology and Biochemistry	182	229
Chemistry	116	121
Engineering	121	114
Environment/Ecology	119	96
Materials Science	66	51
Mathematics	55	55
Plant and Animal Sciences	35	31

QUESTIONS?

APPENDIX

Comparison of Domestic Rankings

	U.S. News UG - National Universities	U.S. News Graduate	Center for Measuring University Performance	NSF HERD
Purpose/About	<ul style="list-style-type: none"> To help prospective undergraduate students and their families find the right college 	<ul style="list-style-type: none"> To help prospective graduate students find programs 	<ul style="list-style-type: none"> To improve the performance of American research universities 	<ul style="list-style-type: none"> Primary source of information on R&D expenditures at U.S. colleges and universities
Population	<ul style="list-style-type: none"> U.S. universities that offer a full ranges of UG majors, plus master's and doctoral programs, and emphasize faculty research 	<ul style="list-style-type: none"> Varies by discipline/program Only includes U.S. institutions 	<ul style="list-style-type: none"> U.S. institutions with \$40+ million in annual federal research expenditures 	<ul style="list-style-type: none"> U.S. institutions that expended at least \$150,000 in separately budgeted R&D in the fiscal year
Frequency	<ul style="list-style-type: none"> Annual Most recent: 2018 edition, released September 2017 	<ul style="list-style-type: none"> Annual to every few years, varies by discipline/program Most recent: 2019 edition, released March 2018 	<ul style="list-style-type: none"> Annual Most recent: 2016 report, released Fall 2017 	<ul style="list-style-type: none"> Annual Most recent: FY 2016 edition, released November 2017
Indicators	<ul style="list-style-type: none"> Academic Reputation Retention & Graduation Graduation Rate Performance Faculty Resources Student Selectivity Financial Resources Alumni Giving 	<ul style="list-style-type: none"> Varies by discipline/program 	<ul style="list-style-type: none"> Total Research Expenditures Federal Research Expenditures Endowment Assets Annual Giving National Academy Members Faculty Awards Doctorates Granted Postdoctoral Appointees SAT Scores 	<ul style="list-style-type: none"> R&D expenditures by field of research and source of funds Also gathers info on types of research and expenses and headcounts of R&D personnel
Data Sources	<ul style="list-style-type: none"> Reputation Surveys Common Data Set 	<ul style="list-style-type: none"> Varies by discipline/program 	<ul style="list-style-type: none"> NSF Surveys IPEDS Surveys NACUBO Endowment Study CAE VSE Survey National Academies directories Award-granting orgs listings 	<ul style="list-style-type: none"> National Science Foundation

U.S. News: Undergraduate Rankings - NC State Trends - 2011 to 2018 Editions

Criteria	Metric		2011	2012	2013	2014	2015		2016		2017		2018		
							Score	Rank	Score	Rank	Score	Rank	Score	Rank	
	National rank		111th	101st	106th	101st	95th		89th		92nd		81st		
	Public national rank		52nd	45th	51st	47th	43rd		37th		38th		33rd		
Academic Reputation	Peer assessment		3.1	3.1	3.1	3	3.1	81	3.1	83	3.1	88	3.2	80	
	High school counselor assessment		3.7	3.6	3.7	3.7	3.8	91	3.7	104	3.6	117	3.5	128	
Graduation & Retention	Freshman retention		90%	90%	91%	91%	91.50%	86	92.25%	87	93%	82	93.5%	81	
	Graduation rate (6 yr - average)		70%	71%	72%	72%	72.5%		73.8%		74.8%		76%		
Graduation Rate Performance	Graduation rate (6 yr - single cohort)		70%	71%	72%	71%	74%	130	76%	73	76%	84	78%	70	
	Predicted Graduation Rate		75%	74%	70%	71%	74%		72%		72%		72%		
Faculty Resources	% Classes with < 20 students	Class Size Indicator Rank used in 2017+	29%	30%	21%	27%	28.0%	176	28.3%	178	227	157	194	138	
	% Classes with ≥ 50 students		20%	20%	23%	18%	17.1%		16.8%				13/1		
	Student/faculty ratio		17/1	18/1	18/1	18/1	17/1		16/1		14/1		94.80%		
	% Full time faculty		97%	97%	97%	97%	94.6%		93.9%		95.1%		\$132.61		
	Faculty compensation (x 1,000)		\$88.10	\$88.50	\$88.50	N/A	\$102.00		\$118.00		\$127.57		91.9%		
	Faculty with terminal degree		87%	87%	88%	88%	88.9%		90.7%		92.4%				
Student Selectivity	SAT of entering freshmen 25th/75th percentile		1080-1280	1090-1280	1090-1280	1130-1300	1150-1320	71	1160-1330	69	1160-1330	70	1170-1350	64	
							633		641		640		646		
	Average Math SAT						601		607		610		617		
	Average Verbal SAT						27		28		29		29		
	Composite ACT								52%		51%		50%		
	% Entering freshmen in top 10% of HS class		41%	42%	43%	49%	50%		51.42%		50.14%		46%		
	Acceptance rate		55%	54%	52%	50%	46.87%								
Alumni Giving	Alumni giving rate		11%	11%	11%	12.8%	13.1%	90	12.6%	93	12.3%	88	11.5%	86	
Financial Resources	Educational expenditures / student		85	90	106	102	\$31,443	97	\$32,713	96	\$33,225	98	\$35,086	97	
	Overall score						47		46		50		54		

U.S. News: UG Rankings
NC State, Peers and UNC-CH
2018 Edition

Note: Shading indicates values that are below NC State's for a given metric

		Weight of Metric		15%	7.5%		4.5%	18%	7.5%				8%	1%	1%	7%	3%
Rank	Tie	School	Overall score	Peer Assessment	HS Counselor assessment	Graduation & retention rank	Average .freshman retention	Average 6-yr graduation	Predicted 6-yr graduation	Actual 6-yr graduation	Over/ under performance	Faculty resources rank	Class Size Indicator Rank	Student/ faculty ratio	% Full Time Faculty	Faculty Compensation Rank	Faculty with Terminal Degree
30	*	UNC-CH	71	4	4.5	28	97%	90.25%	89%	90%	1	94	186	13/1	92%	52	86%
34	*	Georgia Tech	68	4.2	4.5	41	97%	83.75%	90%	86%	-4	178	271	20/1	97%	35	81%
42	*	U. of Florida	65	3.7	3.9	34	96%	87.25%	83%	87%	4	89	157	20/1	93%	65	89%
46	*	U. of Wisconsin	64	3.9	4.2	49	93%	84.25%	86%	85%	-1	106	263	20/1	89%	27	92%
46	*	UC-Davis	64	4	4	41	95%	83.5%	83%	85%	2	124	208	18/1	94%	87	91%
52	*	U. of Illinois	63	3.9	3.9	47	94%	84.5%	82%	85%	3	83	220	20/1	100%	35	94%
52	*	Penn State	63	3.7	3.9	41	93%	85.75%	65%	86%	21	166	271	16/1	96%	35	81%
54	*	Ohio State	62	3.8	4.1	49	94%	83.25%	78%	84%	6	166	274	19/1	88%	81	98%
56	*	Purdue	61	3.8	4.2	92	92%	73.75%	70%	77%	7	74	220	12/1	95%	57	98%
61	*	U. of Maryland	60	3.6	4	38	95%	85.5%	84%	87%	3	128	176	17/1	88%	119	91%
69	*	Texas A & M	57	3.4	4.0	70	92%	79.25%	71%	80%	9	106	233	13/1	73%	62	99%
69	*	Virginia Tech	57	3.6	4.1	73	91%	83.25%	76%	80%	4	184	294	21/1	92%	28	89%
69	*	Rutgers	57	3.5	4.1	49	93%	79.75%	74%	84%	10	166	278	14/1	96%	65	90%
81	*	Michigan State	54	3.6	3.8	77	92%	78%	68%	78%	10	210	280	17/1	95%	94	90%
81	*	NCState	54	3.2	3.5	81	94%	76%	72%	78%	6	138	194	13/1	95%	126	92%
115	*	Iowa State	47	3.3	3.5	104	87%	70.5%	68%	74%	6	194	281	19/1	94%	77	93%
124	*	Colorado State	45	3.6	3.7	170	81%	66.75%	63%	60%	-3	145	194	22/1	94%	94	89%
124	*	U. of Arizona	45	3	3.5	133	87%	60.5%	63%	67%	4	128	239	18/1	99%	103	100%

U.S. News: UG Rankings
NC State, Peers and UNC-CH
2018 Edition

Note: Shading indicates values that are below NC State's for a given metric

		Weight of Metric	
Rank	Tie	School	Overall score
30	*	UNC-CH	71
34	*	Georgia Tech	68
42	*	U. of Florida	65
46	*	U. of Wisconsin	64
46	*	UC-Davis	64
52	*	U. of Illinois	63
52	*	Penn State	63
54	*	Ohio State	62
56	*	Purdue	61
61	*	U. of Maryland	60
69	*	Texas A & M	57
69	*	Virginia Tech	57
69	*	Rutgers	57
81	*	Michigan State	54
81	*	NCState	54
115	*	Iowa State	47
124	*	Colorado State	45
124	*	U. of Arizona	45

Student Selectivity				Financial Resources		Alumni Giving	
	8.125%	3.125%	1.25%	10%		5%	
Selectivity rank	SAT/ACT 25-75%	Freshmen top 10%	Acceptance rate	Financial resources rank	Educational expenditures per student	Alumni giving rank	Average alumni giving
39	1190-1410	73%	27%	27	\$66,662	51	17%
22	1320-1500	87%	26%	55	\$47,917	26	23.8%
47	1180-1370	73%	46%	49	\$51,996	86	11.6%
57	1050-1330	100%	42%	61	\$46,560	67	13.3%
52	1234-1420	54%	53%	32	\$63,519	162	7.2%
60	1280-1480	49%	60%	61	\$46,803	127	8.4%
104	1090-1300	36%	56%	52	\$49,250	67	13.8%
52	1160-1410	63%	54%	76	\$39,756	63	14.3%
84	1080-1330	43%	56%	87	\$35,636	41	18.7%
47	1210-1420	71%	48%	87	\$36,011	152	7.7%
96	1110-1350	41%	57%	87	\$35,733	47	17.4%
80	1070-1310	66%	66%	114	\$31,143	92	11.2%
124	1100-1320	40%	71%	76	\$39,599	140	8%
110	990-1260	30%	66%	103	\$33,356	140	8%
64	1170-1350	50%	46%	97	\$35,086	86	11.5%
140	980-1270	22%	87%	147	\$27,742	79	12.3%
160	970-1220	28%	79%	158	\$26,473	102	10.5%
148	1020-1250	21%	78%	87	\$36,112	162	7.2%

Center for Measuring University Performance

NC State, Peers and UNC-CH - 2016 Report

Note: Shading indicates values that are below NC State's for a given metric

Institution	Public Rank	Number of Measures in Top 25 Public	Number of Measures in Top 26-50 Public
Ohio State	1	9	0
U. of Illinois	1	9	0
UNC-CH	1	9	0
U. of Wisconsin	1	9	0
U. of Florida	9	8	1
Texas A&M	13	8	0
Georgia Tech	14	7	1
Purdue	15	6	3
UC-Davis	15	6	3
Penn State	18	6	2
U. of Arizona	18	6	2
U. of Maryland	18	6	2
Rutgers	21	5	4
Michigan State	23	4	4
NC State	27	2	7
Virginia Tech	28	2	6
Iowa State	42	0	6
Colorado State	46	0	5

Research				Private Support			
2014 *** Total Research x \$1000	2014 *** Control Rank (Public)	2014 *** Federal Research x \$1000	2014 *** Control Rank (Public)	2015 *** Endowment Assets x \$1000	2015 *** Control Rank (Public)	2015 *** Annual Giving x \$1000	2015 *** Control Rank (Public)
752,836	11	416,177	12	3,633,887	6	359,798	6
598,531	19	336,172	14	1,530,658	21	177,235	19
955,601	6	601,933	3	2,988,806	11	301,177	10
984,830	5	522,251	7	2,792,622	12	330,454	8
652,341	17	279,920	22	1,555,703	20	215,580	14
735,273	12	266,877	25	9,856,983	3	255,179	11
720,248	13	510,422	8	1,858,977	16	119,118	42
502,457	23	227,857	30	2,397,902	14	172,219	22
699,689	16	327,697	16	1,013,936	30	185,840	17
702,912	15	461,896	10	1,854,222	17	155,658	26
575,864	20	286,595	20	767,940	44	190,184	16
472,235	26	328,828	15	482,628	68	122,694	37
627,076	18	355,116	13	710,802	47	127,846	34
492,501	24	247,970	26	2,673,652	13	131,499	31
440,392	27	177,722	44	983,979	32	119,150	41
502,486	22	198,092	37	817,759	41	86,391	60
297,293	48	115,285	57	786,205	43	105,512	49
300,572	47	206,958	33	281,355	99	41,342	92

Center for Measuring University Performance

NC State, Peers and UNC-CH - 2016 Report

Note: Shading indicates values that are below NC State's for a given metric

Institution	Public Rank	Number of Measures in Top 25 Public	Number of Measures in Top 26-50 Public
Ohio State	1	9	0
U. of Illinois	1	9	0
UNC-CH	1	9	0
U. of Wisconsin	1	9	0
U. of Florida	9	8	1
Texas A&M	13	8	0
Georgia Tech	14	7	1
Purdue	15	6	3
UC-Davis	15	6	3
Penn State	18	6	2
U. of Arizona	18	6	2
U. of Maryland	18	6	2
Rutgers	21	5	4
Michigan State	23	4	4
NC State	27	2	7
Virginia Tech	28	2	6
Iowa State	42	0	6
Colorado State	46	0	5

Faculty				Advanced Training				Undergraduate	
2015 *** Control Academy Members	2015 *** Control Rank (Public)	2015 *** Faculty Awards	2015 *** Control Rank (Public)	2015 *** Doctorates Awarded	2015 *** Control Rank (Public)	2014 *** Postdocs	2014 *** Control Rank (Public)	2014 *** Median SAT	2014 *** Control Rank (Public)
32	16	17	21	832	4	629	15	1300	12
56	9	30	6	829	5	525	17	1300	12
38	15	19	17	519	22	802	8	1320	9
77	7	30	6	857	3	767	9	1280	17
25	26	23	10	754	8	644	13	1265	22
27	22	14	25	740	9	386	25	1195	53
31	18	21	12	526	21	217	51	1400	1
27	22	19	17	717	11	358	28	1205	49
45	11	12	30	553	18	765	10	1205	49
27	22	19	17	673	14	365	27	1190	56
31	18	9	48	528	20	451	20	N/A	N/A
26	25	20	14	654	15	437	23	1315	10
39	14	20	14	597	16	345	31	1215	43
13	34	11	33	577	17	450	21	1170	66
20	31	11	33	512	23	473	18	1245	27
13	34	10	40	488	25	226	49	1215	43
8	47	6	66	336	42	331	32	1150	80
9	41	11	33	251	59	297	37	1130	98

Comparison of Global Rankings

	QS (Quacquarelli Symonds)	THE (Times Higher Education)	Academic Ranking of World Universities (ARWU/Shanghai Rankings)	U.S. News Global
Purpose/About	<ul style="list-style-type: none"> To help students make informed comparisons of leading universities around the world 	<ul style="list-style-type: none"> Judge world class universities across all of their core missions – teaching, research, knowledge transfer and international outlook 	<ul style="list-style-type: none"> From the Center for World-Class Universities at Shanghai Jiao Tong University; the initial purpose of ARWU was to find the global standing of top Chinese universities 	<ul style="list-style-type: none"> To allow students to compare universities around the world based on academic research and reputation
Population	<ul style="list-style-type: none"> Highlights more than 1,000 universities based on six performance indicators 	<ul style="list-style-type: none"> Research-intensive universities that also teach undergraduates; for 2018, must have a research output of at least 1,000 articles between 2012 and 2016; 1,000 universities ranked 	<ul style="list-style-type: none"> More than 1300 universities are ranked by ARWU every year and the best 500 are individually ranked 	<ul style="list-style-type: none"> Top 250 universities in Clarivate Analytics' global reputation survey AND institutions that published the highest number of articles over last 5 years
Frequency	<ul style="list-style-type: none"> Annual Most recent: 2019 edition released June 2018 	<ul style="list-style-type: none"> Annual Most recent: 2018 edition released September 2017 	<ul style="list-style-type: none"> Annual Most recent: 2017 edition, released February 2018 	<ul style="list-style-type: none"> Annual Most recent: 2018 edition, released October 2017
Indicators	<ul style="list-style-type: none"> Academic Reputation 40% Employer Reputation 10% Faculty to Student Ratio 20% Citations Per Faculty 20% International Faculty Ratio 5% International Student Ratio 5% 	<ul style="list-style-type: none"> Teaching (the learning environment) 30% Research (volume, income & reputation) 30% Citations (research influence) 30% Int'l outlook (staff, students & research) 7.5% Industry income (knowledge transfer) 2.5% 	<ul style="list-style-type: none"> Quality of education (alumni who won Nobel and Fields Medals) 10% Quality of faculty (Nobel and Fields Medal winners, highly-cited researchers) 40% Research output (citations, papers published in high-impact journals) 40% Per capita academic performance 10% 	<ul style="list-style-type: none"> Global Research Reputation 12.5% Regional Research Reputation 12.5% Bibliometrics (publications, books, conferences, citations, international collaboration) 75%
Data Sources	<ul style="list-style-type: none"> Surveys Scopus 	<ul style="list-style-type: none"> Institutions provide and sign off their institutional data for use in the rankings 	<ul style="list-style-type: none"> Multiple, including highlycited.com (Thompson Reuters) and Web of Science 	<ul style="list-style-type: none"> Surveys Web of Science

QS World University Rankings

NC State: 2017 to 2019 Editions

Indicator	Weight	2017		2018		2019	
		Score	Rank	Score	Rank	Score	Rank
Overall Score and Rank		38	277	40.3	263	35.7	279
Academic Reputation	40%	36.2	279	41.3	250	32	254
Employer Reputation	10%	30.2	401+	21.5	401+	12.7	501+
Faculty Student	20%	29.1	436	36	361	35.2	432
Citations	20%	50.1	228	46.7	264	47	265
International Faculty	5%	40.1	343	60.8	261	64.6	265
International Students	5%	51.8	294	40	355	38.3	362

QS World University Rankings

NC State, Peers and UNC-CH: 2012 to 2019 Editions

Peers - Overall Rank	2012	2014*	2015	2016	2017	2018	2019**
U. of Wisconsin	38	37	41	54	53	55	53
Georgia Tech	88	99	107	84	71	70	69
U. of Illinois	56	56	63	59	66	69	71
UNC-CH	57	54	62	79	78	80	83
Ohio State	105	113	109	99	88	86	89
Penn State	101	107	112	101	95	93	95
UC-Davis	100	85	95	85	85	118	100
Purdue	95	99	102	89	92	105	100
U. of Maryland	117	116	122	126	131	129	126
Michigan State	174	171	195	164	160	149	141
U. of Florida	169	179	192	180	185	178	180
Texas A&M	165	153	165	159	160	195	203
U. of Arizona	183	212	215	216	233	230	246
NC State	291	304	388	309	277	263	279
Rutgers	260	255	279	269	301	283	283
Virginia Tech	337	316	355	338	361	367	338
Colorado State	365	394	441+	411+	386	481+	450
Iowa State	319	321	348	355	421+	471+	489

* No rankings given for 2013

** Table ordered by 2019 rankings

Times Higher Education NC State, Peers and UNC-CH 2018 Edition

Institution	2018 Rank	Tie
Georgia Tech	33	
U. of Illinois	37	
U. of Wisconsin	43	
UC-Davis	54	Y
UNC-CH	56	Y
Purdue	60	
U. of Maryland	69	
Ohio State	70	Y
Penn State	77	
Michigan State	83	Y
U. of Florida	143	Y
Texas A&M	159	Y
U. of Arizona	161	
Rutgers	172	
NC State	251-300	Y
Iowa State	301-350	Y
Virginia Tech	301-350	Y
Colorado State	351-400	Y

Academic Ranking of World Universities NC State, Peers and UNC-CH 2017 Edition

Institution	2017 World Rank	Tie	2017 USA Rank	Tie	2017 Score
U. of Wisconsin	28		21		39.7
UNC-CH	33		23		36.9
U. of Illinois	37		26		36.2
U. of Maryland	53		32		31.8
Purdue	77		38		28
Rutgers	79		39		27.8
Ohio State	80	Y	40	Y	27.7
Georgia Tech	85	Y	43	Y	27.1
Penn State	85	Y	43	Y	27.1
UC-Davis	85	Y	43	Y	27.1
U. of Florida	88	Y	46		27
U. of Arizona	99	Y	48		25.9
Michigan State	101-150	Y	49-60	Y	-
Texas A&M	101-150	Y	49-60	Y	-
Colorado State	201-300	Y	71-99	Y	-
Iowa State	201-300	Y	71-99	Y	-
NC State	201-300	Y	71-99	Y	-
Virginia Tech	301-400	Y	100-119	Y	-

U.S. News: Best Global University - NC State, Peers and UNC-CH - 2018 Edition

	Weight of Metric		12.5%	12.5%	10%	2.5%	2.5%	10%	7.5%	12.5%	10%	5%	5%	5%	5%
Global Rank	School	Global score	Global research reputation rank	Regional research reputation rank	Publications rank	Books rank	Conferences rank	Normalized citation impact rank	Total citations rank	# of publications among the 10% most cited rank	% of publications among the 10% most cited rank	International collaboration rank	% of total publications w/ international collaboration rank	Number of highly cited papers among top 1% most cited rank	% of total publications that are among the top 1% rank
31	U. of Wisconsin	74.9	28	17	35	32	167	107	28	28	104	443	748	31	140
34	UNC-CH	74.5	41	23	51	84	419	62	34	31	45	777	843	26	57
46	Ohio State	72.6	53	28	36	52	110	137	33	32	119	372	727	34	193
50	U. of Maryland	71.8	83	43	92	54	95	75	70	70	74	90	535	65	89
51	U. of Illinois	71.6	23	19	68	78	45	191	68	62	132	232	662	75	253
52	UC-Davis	71.5	55	41	43	65	214	163	38	38	133	141	592	45	198
66	Penn State	70.2	39	26	45	47	71	251	50	49	204	313	706	64	291
71	Georgia Tech	69.4	34	25	150	139	15	220	133	112	105	119	573	112	121
77	U. of Arizona	68.7	87	39	103	66	158	149	91	90	143	89	534	83	159
81	Michigan State	67.5	69	37	108	97	163	149	95	94	160	222	657	114	264
95	U. of Florida	66.3	88	47	41	41	156	384	54	57	376	215	650	62	310
97	Rutgers	66.2	85	40	84	33	220	237	87	84	220	258	677	97	269
102	Purdue	63.8	46	34	98	92	32	337	106	101	277	282	689	129	382
118	Texas A & M	66.9	75	46	94	100	74	414	111	109	391	121	577	139	450
204	Iowa State	57.6	178	68	215	224	238	369	204	211	365	195	636	207	338
222	NC State	56.9	146	54	170	168	140	505	191	177	419	571	782	219	496
250	Colorado State	54.7	230	71	281	254	411	401	268	257	338	448	794	297	630
250	Virginia Tech	54.7	138	58	204	224	84	525	233	228	474	611	749	234	272

Note: Shading indicates values that are below NC State's for a given metric